



Below is a list of information that is required to be submitted with building plans for MSD staff to process the request. All plans must be drawn to a common scale,  $\frac{1}{4}'' = 1'$  or larger, and must clearly indicate the location, nature, and extent of the proposed work. Plans lacking adequate detail will not be approved.

**Reminder: This is meant to be a helpful guide, not a comprehensive list.**

## 1. Building Plans

- Electronic building plans must be submitted with online permit application

## 2. Additional Information

The following items are required to be included in all Residential Basement Finish submittals:

- Square footage
- Floor plans of existing and proposed layout
- Existing and proposed window sizes
- Existing and proposed door swings
- Proposed use of each room
- Existing and proposed electrical layout
  - New electrical layout must include panel amp size and location, as well as and GFCI locations
- Existing and proposed HVAC (water heaters, air conditioning units, furnaces, etc.)
- Proposed stair sections depicting riser heights, treads, handrails, and guardrails
- Locations of smoke and carbon monoxide detectors
- Energy conservation code compliance
- Gas line schematics providing size, lengths, and total BTU or CFH at service outlets from meter
- Certain structural details must be stamped by a Utah licensed structural engineer, including the modification of load bearing walls
- Second kitchen agreement for all projects that include a second kitchen
- Show window wells with the dimensions noted





GREATER SALT LAKE

**Municipal Services District**

# RESIDENTIAL BASEMENT FINISH EXAMPLE

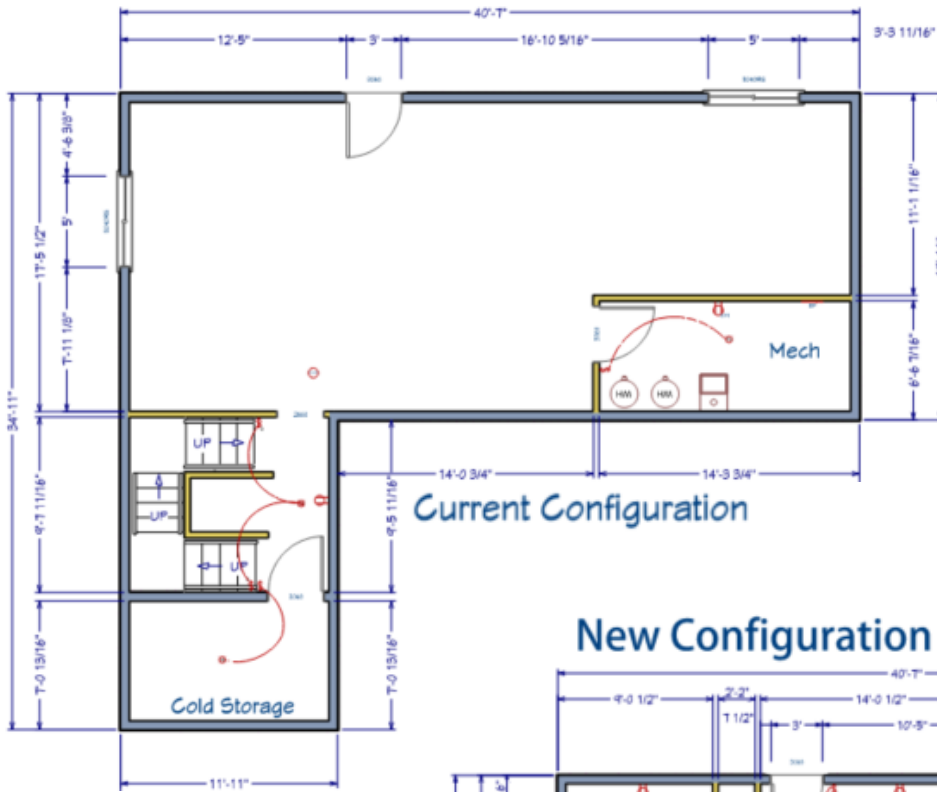

## Scope of Work

- Firestop all perimeter walls
- 2"x4" Framing 16" on center
- Firestop all chases at floor and ceiling
- SD Detectors 120 V interconnected all bedrooms and hallways leading to bedrooms, with battery backup
- All Bath plugs to be GFI and 20 amp
- Exhaust fans to vent to outside
- All outlets to be tamper proof
- All bedrooms to have egress ladders in window wells
- All exterior walls to be insulated with R-19
- All work compliant with current IBC/ICC code.

